

# FACT SHEET

## Home Escape Plan

Escape plans are essential for schools, pre-schools and for the home.

- Draw a plan of your home or building.
- Plan two ways out of every room, including bedrooms.
- Make special arrangements for children and the disabled.
- Be sure that all locks can be unlocked quickly.
- If an escape path is from above the ground floor, make sure there is a safe way down.
- Choose a meeting place away from danger, preferably to the front of the property (a gate-post, letter-box or a particular tree)
- Practice your escape plan at least twice per year, not by walking or running but by crawling low to reach safety.
- Practice your escape plan beginning in different rooms of the house.
- Keep a copy of your escape plan in a prominent place ( a notice board or fridge door).

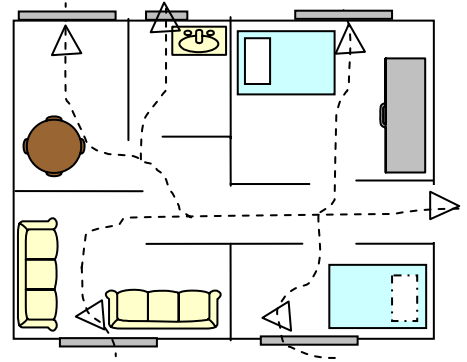

Draw a plan of your home and keep it in a prominent place.



Choose a meeting place away from danger, preferably to the front of the property.



Special arrangements will need to be made for children or the disabled.